

SOLUÇÕES PARA REFRIGERAÇÃO  
SOLUCIONES PARA REFRIGERACION

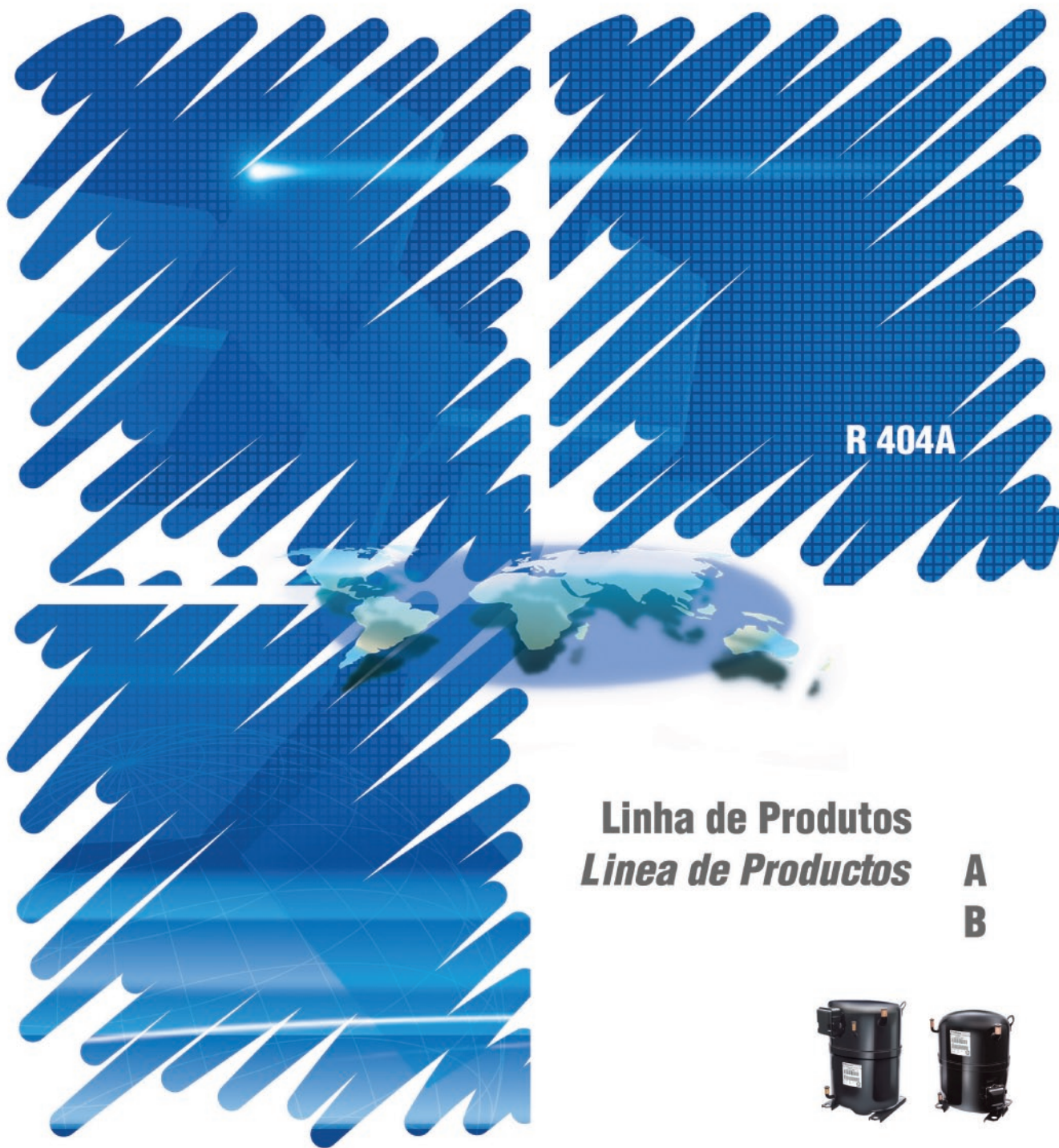

R 404A

**Linha de Produtos**  
**Linea de Productos**

**A**  
**B**



**embraco**

# R 404A

## Refrigeração Comercial

Impulsionada pela visão Embraco "Ser em todos os mercados o fornecedor preferencial de soluções para refrigeração", a Embraco oferece a seus clientes uma gama de compressores para refrigeração anteriormente não disponível em sua linha.

São as linhas de compressores para refrigeração comercial Embraco Aspera A e B para aplicações com R 404A. As capacidades de refrigeração dos produtos vão de 4400 a 18100 Btu/h (LBP), e de 6610 a 32000 Btu/h (MBP).

Embraco Aspera: produtos fabricados dentro dos mais altos padrões de desempenho.



Produzidos pela Bristol nos Estados Unidos  
 Producidos por Bristol en los Estados Unidos

## Refrigeración Comercial

Impulsada por la visión de Embraco "Ser en todos los mercados el proveedor preferencial de soluciones para refrigeración", Embraco ofrece a sus clientes una gama de compressores para refrigeración anteriormente no disponible en su línea.

Son las líneas de compressores para refrigeración comercial Embraco Aspera A y B para aplicaciones con R 404A. Las capacidades de refrigeración de los productos van de 4400 a 18100 Btu/h (LBP), y de 6610 a 32000 Btu/h (MBP).

Embraco Aspera: productos fabricados dentro de los más altos estándares de desempeño.

## Compressores / Compresores

A

B

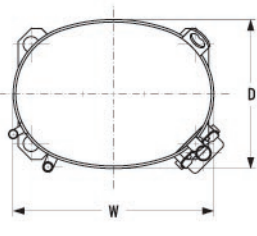
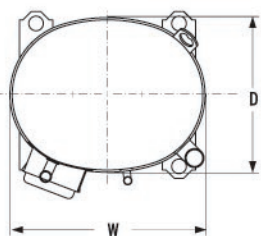
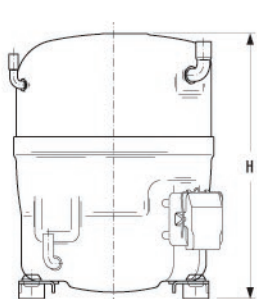
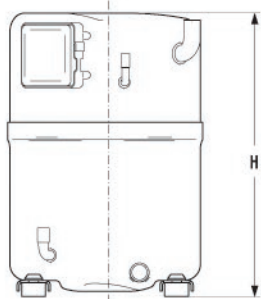

PASSADORES / PASADORES	COMPRESSORES / COMPRESORES	
	A mm (pol/pul)	B mm (pol/pul)
MATERIAL / MATERIAL	Cobre / Cobre	Cobre / Cobre
S - SUÇÃO / SUCCIÓN	19,0 (3/4)	15,9 (5/8)
D - DESCARGA / DESCARGA	12,7 (1/2)	9,5 (3/8)
P - PROCESSO / PROCESO	9,5 (3/8)	9,5 (3/8)



# LBP R404A

# Dados de Produto / Datos del Producto

Hz	HP	Modelo	Voltagem / Voltage (V-Ph-Hz)	Capacidade Nominal / Capacidad Nominal @ ASHRAE			Relé de Partida / Relay de Arranque	Capacitor de Partida / Capacitor de Arranque (µF)	Capacitor de Funcionamento / Capacitor de Marcha (µF)	Dimensões / Dimensiones		
				Btu/h	W	kcal				mm (polegadas / pulgadas)		
										H	W	D
50	1	L63B562DBDB	220/200-3-50	4500	1319	1134	N/A	N/A	N/A	327,81 (12,906)	247,65 (9,750)	184,15 (7,250)
	1	L63B562DBEB	380/415-3-50	4500	1319	1134	N/A	N/A	N/A	327,81 (12,906)	247,65 (9,750)	184,15 (7,250)
	1	L63B562BBKB**	220/240-1-50	4400	1289	1109	GE 3ARR3*3AV*	161-193/250	15/370	327,81 (12,906)	247,65 (9,750)	184,15 (7,250)
	1 1/4	L63B652DBDB	220/200-3-50	5200	1524	1310	N/A	N/A	N/A	327,81 (12,906)	247,65 (9,750)	184,15 (7,250)
	1 1/4	L63B652DBEB	380/415-3-50	5200	1524	1310	N/A	N/A	N/A	327,81 (12,906)	247,65 (9,750)	184,15 (7,250)
	2	L63B752DBDB	220/200-3-50	6350	1861	1600	N/A	N/A	N/A	327,81 (12,906)	247,65 (9,750)	184,15 (7,250)
	2	L63B752DBEB	380/415-3-50	6350	1861	1600	N/A	N/A	N/A	327,81 (12,906)	247,65 (9,750)	184,15 (7,250)
	3	L63A113DBLA	220/200-3-50	9000	2637	2268	N/A	N/A	N/A	378,61 (14,906)	260,35 (10,250)	206,37 (8,125)
	3	L63A113DBEA	380/415-3-50	8600	2520	2167	N/A	N/A	N/A	378,61 (14,906)	260,35 (10,250)	206,37 (8,125)
	3	L63A113BBKA	220/240-1-50	9200	2696	2318	GE 3ARR3*10AU*	161-193/250	25/440	378,61 (14,906)	260,35 (10,250)	206,37 (8,125)
	4	L63A183DBDA	220/200-3-50	15000	4395	3780	N/A	N/A	N/A	378,61 (14,906)	260,35 (10,250)	206,37 (8,125)
	4	L63A183DBEA	380/415-3-50	15000	4395	3780	N/A	N/A	N/A	378,61 (14,906)	260,35 (10,250)	206,37 (8,125)
	2	L63B752DBL	200/220-3-50	6100	1787	1537	N/A	N/A	N/A	327,81 (12,906)	247,65 (9,750)	184,15 (7,250)
	2	L63B752DBV	380/415-3-50	6100	1787	1537	N/A	N/A	N/A	327,81 (12,906)	247,65 (9,750)	184,15 (7,250)
	4	L63A183BBKA	220/240-1-50	14400	4220	3629	GE 3ARR3T4AA3	270-324/330V	35/440	416,71 (16,406)	260,35 (10,250)	206,37 (8,125)
	60	1	L63B562BBAB	115-1-60	5350	1568	1348	GE 3ARR3*255*	189-227/250	20/370	327,81 (12,906)	247,65 (9,750)
1		L63B562BBCB**	230/208-1-60	5350	1568	1348	GE 3ARR3*3V*	161-193/250	30/370	327,81 (12,906)	247,65 (9,750)	184,15 (7,250)
1		L63B562DBD	230/208-3-60	5350	1568	1348	N/A	N/A	N/A	327,81 (12,906)	247,65 (9,750)	184,15 (7,250)
1		L63B562DBEB	460-3-60	5350	1568	1348	N/A	N/A	N/A	327,81 (12,906)	247,65 (9,750)	184,15 (7,250)
1 1/4		L63B652BBCB**	230/208-1-60	6200	1817	1562	GE 3ARR3*3V*	161-193/250	20/370	343,69 (13,531)	247,65 (9,750)	184,15 (7,250)
1 1/4		L63B652DBDB	230/208-3-60	6200	1817	1562	N/A	N/A	N/A	327,81 (12,906)	247,65 (9,750)	184,15 (7,250)
1 1/4		L63B652DBEB	460-3-60	6200	1817	1562	N/A	N/A	N/A	327,81 (12,906)	247,65 (9,750)	184,15 (7,250)
2		L63B752BBCB**	230/208-1-60	7290	2136	1837	GE 3ARR3*3V*	30/370	161-193/250	343,69 (13,531)	247,65 (9,750)	184,15 (7,250)
2		L63B752DBDB	230/208-3-60	7600	2227	1915	N/A	N/A	N/A	327,81 (12,906)	247,65 (9,750)	184,15 (7,250)
2		L63B752DBEB	460-3-60	7600	2227	1915	N/A	N/A	N/A	327,81 (12,906)	247,65 (9,750)	184,15 (7,250)
3		L63A113BBCA	230/208-1-60	10700	3135	2696	GE 3ARR3*26C*	161-193/250	20/440	378,61 (14,906)	260,35 (10,250)	206,37 (8,125)
3		L63A113DBLA	230/200-3-60	10800	3165	2722	N/A	N/A	N/A	378,61 (14,906)	260,35 (10,250)	206,37 (8,125)
3		L63A113DBEA	460-3-60	10800	3165	2722	N/A	N/A	N/A	378,61 (14,906)	260,35 (10,250)	206,37 (8,125)
4		L63A183BBCA	230/208-1-60	18100	5304	4561	GE 3ARR3T4B3	216/259/330V	35/440	378,61 (14,906)	260,35 (10,250)	206,37 (8,125)
4		L63A183DBDA	230/208-3-60	18000	5274	4536	N/A	N/A	N/A	378,61 (14,906)	260,35 (10,250)	206,37 (8,125)
2		L63B752DBV**	460/380-3-60	7436	2179	1874	N/A	N/A	N/A	327,81 (12,906)	247,65 (9,750)	184,15 (7,250)
2	L63B752DBL**	230/200-3-60	7250	2124	1827	N/A	N/A	N/A	327,81 (12,906)	247,65 (9,750)	184,15 (7,250)	
4	L63A183DBEA	460-3-60	18000	5274	4536	N/A	N/A	N/A	378,61 (14,906)	260,35 (10,250)	206,37 (8,125)	

N/A - Não Aplicável / No Aplicable

\*\* Em Desenvolvimento / \*\* En fase de Desarrollo

CONDIÇÕES DE TESTE / CONDICIONES DE PRUEBA	LBP ASHRAE °C (°F)	MBP ASHRAE °C (°F)
Temperatura de Evaporação / Evaporación	-23,3 (-10)	-6,7 (20)
Temperatura de Condensação / Condensación	54,4 (130)	48,9 (120)
Temperatura Ambiente / Ambiente	32,2 (90)	35 (95)
Temperatura de Líquido / Líquido	32,2 (90)	48,9 (120)
Temperatura do Gás de Retorno / del Gas de Retorno	32,2 (90)	4,4 (40)



# MBP R404A

# Dados de Produto / Datos del Producto

Hz	HP	Modelo	Voltagem / Voltage (V-Ph-Hz)	Capacidade Nominal / Capacidad Nominal @ ASHRAE			Relé de Partida / Relay de Arranque	Capacitor de Partida / Capacitor de Arranque (µF)	Capacitor de Funcionamento / Capacitor de Marcha (µF)	Dimensões / Dimensiones			
				Btu/h	W	kcal				mm (polegadas / pulgadas)			
										H	W	D	
50	1	M63B872BBKB	220/240-1-50	6610	1937	1666	GE 3ARR3*10AB*	145-175/250	25/370	327,81 (12,906)	247,65 (9,750)	184,15 (7,250)	
	1	M63B982BBKB	220/240-1-50	7450	2183	1877	3ARR3*10AT*	145-175/250	25/370	327,81 (12,906)	247,65 (9,750)	184,15 (7,250)	
	1 1/2	M63B123DBDB	220/230-3-50	10000	2930	2520	N/A	N/A	N/A	327,81 (12,906)	247,65 (9,750)	184,15 (7,250)	
	1 1/2	M63B123BBKB	220/240-1-50	9450	2769	2381	GE 3ARR3*6AV*	125-145/250	25/370	343,69 (13,531)	247,65 (9,750)	184,15 (7,250)	
	2	M63B153BBKB	220/240-1-50	12662	3710	3191	GE 3ARR3*6AV*	161-193/250	30/370	343,69 (13,531)	247,65 (9,750)	184,15 (7,250)	
	2	M63B153DBEB	380/415-3-50	12315	3609	3103	N/A	N/A	N/A	343,69 (13,531)	247,65 (9,750)	184,15 (7,250)	
	2	M63B153DBLB	220/200-3-50	12315	3609	3103	N/A	N/A	N/A	343,69 (13,531)	247,65 (9,750)	184,15 (7,250)	
	2	M63B153DBVB	380-415-3-50	12315	3609	3103	N/A	N/A	N/A	343,69 (13,531)	247,65 (9,750)	184,15 (7,250)	
	2 1/4	M63B203BBKB	220/240-1-50	15945	4672	4018	3ARR3*10AV*	189-227/250	35/370	369,09 (14,531)	247,65 (9,750)	184,15 (7,250)	
	2 1/4	M63B203DBDB	220/230-3-50	16000	4688	4032	N/A	N/A	N/A	343,69 (13,531)	247,65 (9,750)	184,15 (7,250)	
	2 1/2	M63A243DBDA	220/230-3-50	20000	5860	5040	N/A	N/A	N/A	378,61 (14,906)	260,35 (10,250)	206,37 (8,125)	
	2 1/2	M63A243DBEA	380/415-3-50	20000	5860	5040	N/A	N/A	N/A	378,61 (14,906)	260,35 (10,250)	206,37 (8,125)	
	3	M63A273DBDA	220/230-3-50	22010	6449	5547	N/A	N/A	N/A	378,61 (14,906)	260,35 (10,250)	206,37 (8,125)	
	3	M63A273DBEA	380/415-3-50	22770	6672	5738	N/A	N/A	N/A	378,61 (14,906)	260,35 (10,250)	206,37 (8,125)	
	3	M63A273DBFA	500-3-50	20500	6007	5166	N/A	N/A	N/A	378,61 (14,906)	260,35 (10,250)	206,37 (8,125)	
	3 1/2	M63A323DBDA	220/230-3-50	26700	7824	6728	N/A	N/A	N/A	416,71 (16,406)	260,35 (10,250)	206,37 (8,125)	
	1 1/2	M63B123DBL	220/200-3-50	9875	2893	2488	N/A	N/A	N/A	343,69 (13,531)	247,65 (9,750)	184,15 (7,250)	
	3 1/2	M63A323DBL**	200/220-3-50	25000	7326	6300	N/A	N/A	N/A	416,71 (16,406)	260,35 (10,250)	206,37 (8,125)	
	3 1/2	M63A323DBVB	380/415-3-50	25450	7457	6413	N/A	N/A	N/A	416,71 (16,406)	260,35 (10,250)	206,37 (8,125)	
	2 1/2	M63A243DBVB	380/415-3-50	19505	5715	4915	N/A	N/A	N/A	378,61 (14,906)	260,35 (10,250)	206,37 (8,125)	
	2 1/2	M63A243DBL	220/200-3-50	18675	5472	4706	N/A	N/A	N/A	378,61 (14,906)	260,35 (10,250)	206,37 (8,125)	
	3 1/2	M63A323DBEA	380/415-3-50	26700	7824	6728	N/A	N/A	N/A	416,71 (16,406)	260,35 (10,250)	206,37 (8,125)	
	60	1	M63B872BBCB	230/208-1-60	8710	2552	2195	GE 3ARR3*3U*	145-175/250	25/370	327,81 (12,906)	247,65 (9,750)	184,15 (7,250)
		1	M63B982BBCB	230/208-1-60	9500	2784	2394	GE 3ARR3*3U*	145-175/250	25/370	327,81 (12,906)	247,65 (9,750)	184,15 (7,250)
1 1/2		M63B123DBDB	230/208-3-60	12000	3516	3024	N/A	N/A	N/A	327,81 (12,906)	247,65 (9,750)	184,15 (7,250)	
1 1/2		M63B123BBCB	230/208-1-60	11740	3440	2958	GE 3ARR3*24T*	161-193/250	25/440	343,69 (13,531)	247,65 (9,750)	184,15 (7,250)	
2		M63B153BBCB	230/208-1-60	15555	4558	3920	GE 3ARR3*24T*	145-175/250	35/440	343,69 (13,531)	247,65 (9,750)	184,15 (7,250)	
2		M63B153DBEB	460-3-60	15110	4428	3808	N/A	N/A	N/A	343,69 (13,531)	247,65 (9,750)	184,15 (7,250)	
2		M63B153DBVB	460-380-3-60	14500	4249	3654	N/A	N/A	N/A	343,69 (13,531)	247,65 (9,750)	184,15 (7,250)	
2		M63B153DBLB	230-200-3-60	15110	4428	3808	N/A	N/A	N/A	343,69 (13,531)	247,65 (9,750)	184,15 (7,250)	
2 1/4		M63B203BBCB	230/208-1-60	19600	5743	4939	GE 3ARR3*24T*	145-175/250	40/440	343,69 (13,531)	247,65 (9,750)	184,15 (7,250)	
2 1/4		M63B203DBDB	230/208-3-60	19200	5626	4838	N/A	N/A	N/A	343,69 (13,531)	247,65 (9,750)	184,15 (7,250)	
2 1/2		M63A243BBCA	230/208-1-60	24400	7150	6149	GE 3ARR3*4A*	189-277/330	35/440	378,61 (14,906)	260,35 (10,250)	206,37 (8,125)	
2 1/2		M63A243DBDA	230/208-3-60	24000	7033	6048	N/A	N/A	N/A	378,61 (14,906)	260,35 (10,250)	206,37 (8,125)	
2 1/2		M63A243DBEA	460-3-60	24000	7033	6048	N/A	N/A	N/A	378,61 (14,906)	260,35 (10,250)	206,37 (8,125)	
3		M63A273BBCA	230/208-1-60	26650	7809	6716	GE 3ARR3*4A*	189-227/330	35/440	378,61 (14,906)	260,35 (10,250)	206,37 (8,125)	
3		M63A273DBDA	230/208-3-60	26800	7853	6754	N/A	N/A	N/A	378,61 (14,906)	260,35 (10,250)	206,37 (8,125)	
3		M63A273DBEA	460-3-60	26650	7809	6716	N/A	N/A	N/A	378,61 (14,906)	260,35 (10,250)	206,37 (8,125)	
3		M63A273DBFA	575-3-60	26000	7619	6552	N/A	N/A	N/A	378,61 (14,906)	260,35 (10,250)	206,37 (8,125)	
3 1/2		M63A323BBCA	230/208-1-60	30180	8843	7605	GE 3ARR3*4A*	135-155/330	45/440	416,71 (16,406)	260,35 (10,250)	206,37 (8,125)	
3 1/2		M63A323DBDA	230/208-3-60	32000	9377	8064	N/A	N/A	N/A	416,71 (16,406)	260,35 (10,250)	206,37 (8,125)	
2 1/2		M63A243DBL	230/200-3-60	23780	6968	5993	N/A	N/A	N/A	378,61 (14,906)	260,35 (10,250)	206,37 (8,125)	
3 1/2		M63A323DBL	230/200-3-60	30000	8791	7560	N/A	N/A	N/A	416,71 (16,406)	260,35 (10,250)	206,37 (8,125)	
2 1/2		M63A243DBVB	460/380-3-60	23780	6968	5993	N/A	N/A	N/A	378,61 (14,906)	260,35 (10,250)	206,37 (8,125)	
3 1/2		M63A323DBVB	460/380-3-60	30000	8791	7560	N/A	N/A	N/A	416,71 (16,406)	260,35 (10,250)	206,37 (8,125)	
1 1/2		M63B123DBL	230/200-3-60	11800	3458	2974	N/A	N/A	N/A	343,69 (13,531)	247,65 (9,750)	184,15 (7,250)	
3 1/2	M63A323DBEA	460-3-60	32000	9377	8064	N/A	N/A	N/A	416,71 (16,406)	260,35 (10,250)	206,37 (8,125)		

N/A - Não Aplicável / No Aplicable

\*\* Em Desenvolvimento / \*\* En fase de Desarrollo

## Denominação do Compressor / Denominación del Compresor

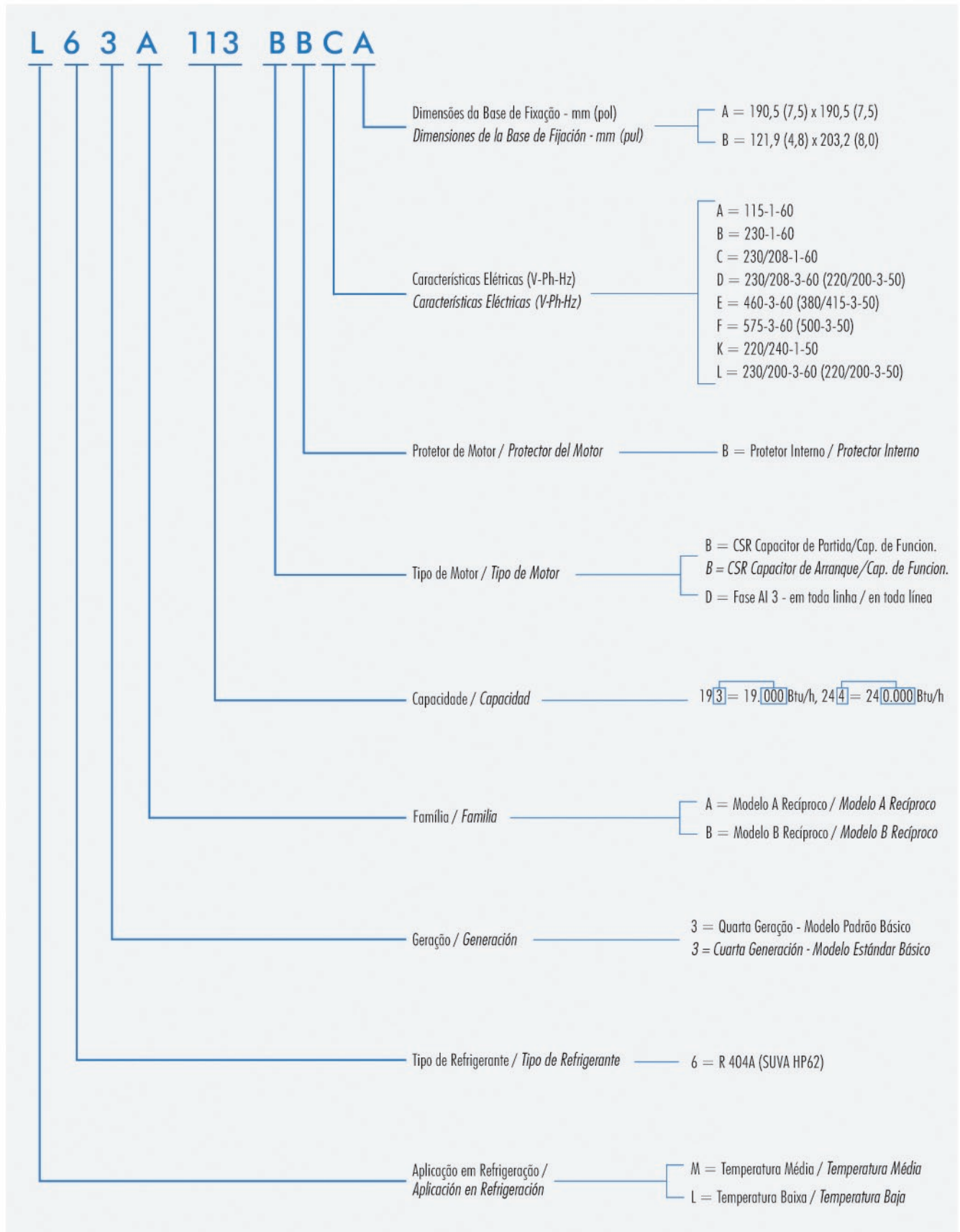





Brasil

Rui Barbosa, 1020 - Caixa Postal 91  
89219-901 - Joinville - SC - Brasil  
Fone/Fano: + 55 47 3441-2121  
Fax: + 55 47 3441-2780



Itália

Via Buttigliera 6  
10020 - Riva Presso Chieri (Turim) - Itália  
Caixa Postal 151 - 10023 Chieri (TO)  
Fone/Fano: + 39 011 943-7111  
Fax: + 39 011 946-8377  
+ 39 011 946-9950

Sales Office  
Zona Industriale D1 - Via Fratelli Gambino, 7  
10023 - Chieri (Turim) - Itália  
Fone/Fano: + 39 011 940-5611  
Fax: + 39 011 940-5656



Eslováquia

Odorinska Cesta, 2 - 052-01  
Spišská Nová Ves - Eslováquia  
Fone/Fano: + 42 153 417-2291  
+ 42 153 417-2293  
Fax: + 42 153 417-2299

Sales Office  
Zona Industriale D1 - Via Fratelli Gambino, 7  
10023 - Chieri (Turim) - Itália  
Fone/Fano: + 39 011 940-5611  
Fax: + 39 011 940-5656



E.U.A.

2800 Vista Ridge Drive NE  
Suwanee, GA 30024-3510  
Fone/Fano: +1 678 804-1337  
Fax: +1 678 804-1338

México - Sales Office  
Torre Alestra, Piso 3 - Office 373  
Av. Lázaro Cárdenas 2321 Pte.  
C. P. 66260 - San Pedro Garza García  
Nuevo León - México  
Fone/Fano: +52 81 1001-7102  
Fax: +52 81 1001-7142



China

29 Yuhua Road  
Area B of Beijing Tianzhu Airport Industrial Zone  
101312 - Beijing - China  
Fone/Fano: +86 10 8048-2255  
Fax: +86 10 6725-6825