

BRAZIL LINE

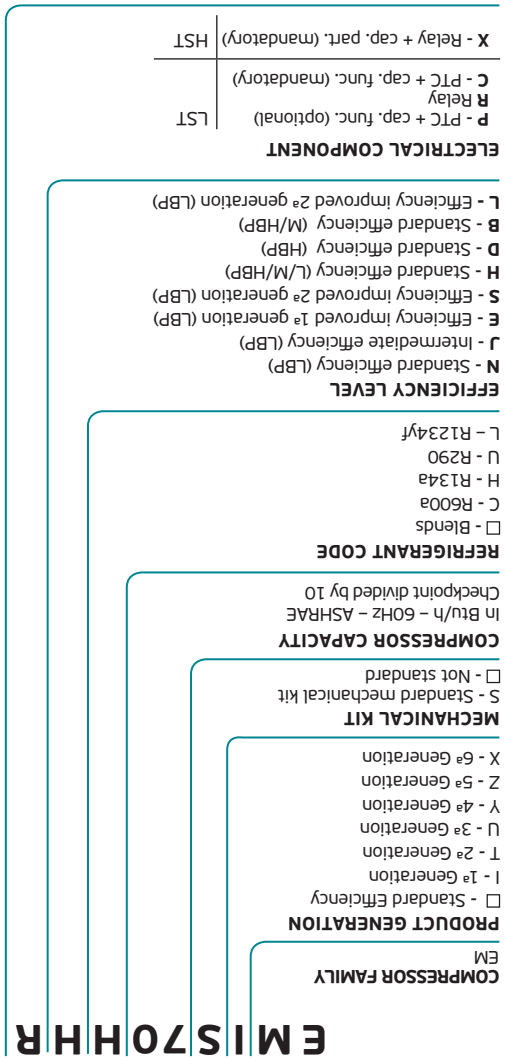

BRAZIL LINE

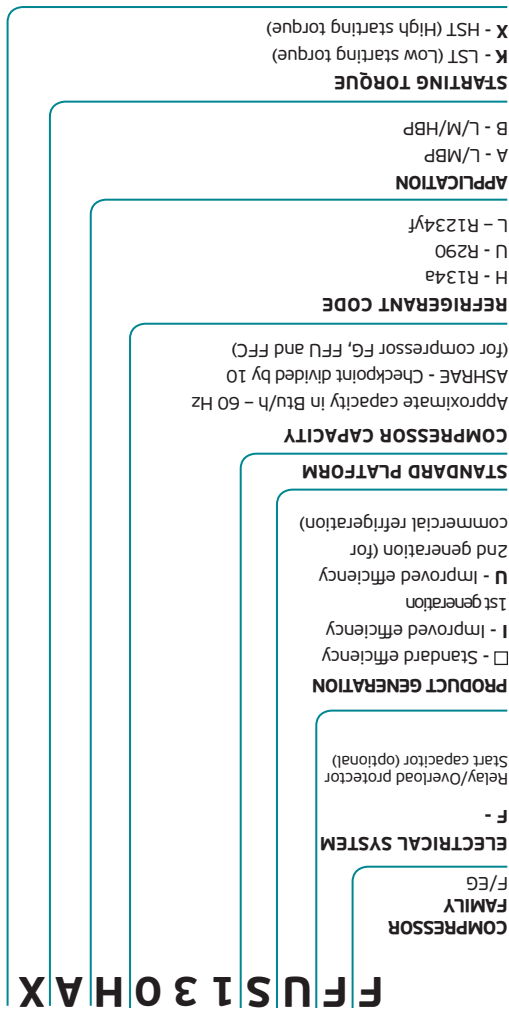

EUROPE LINE

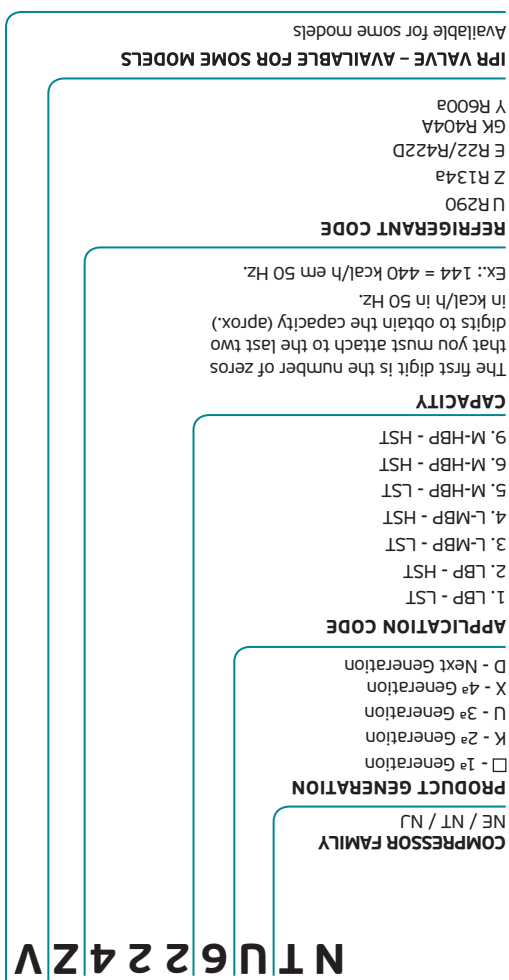

CHINA LINE

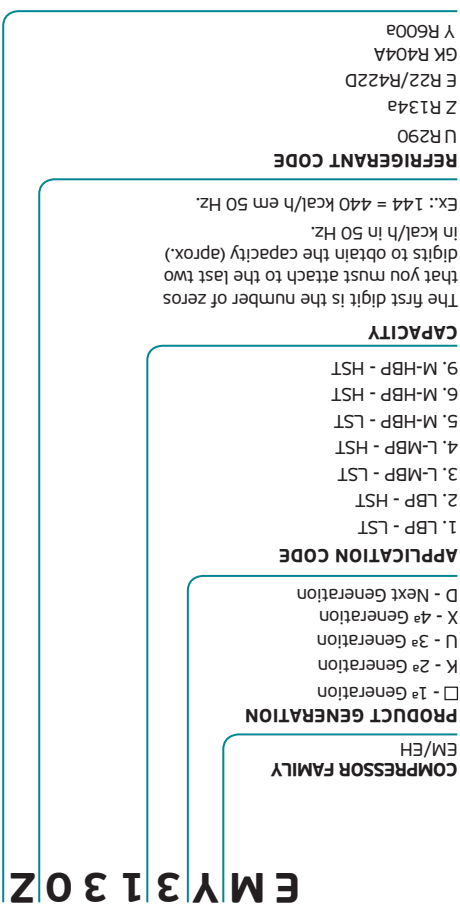

COMPRESSORS LINE

Asia Pacific Catalogue



embraco
Nidec

MAIN RECOMMENDATIONS

- I. Check if the compressor is disconnected from the power grid.
- II. You must never remove the compressor without first removing all the refrigerant inside the system. You can use refrigerant recovery. In the case of replacing compressors with flammable refrigerants, such as R290 or R600a, make sure to remove the whole charge from the system.
- III. You must always use a pipe cutter to disconnect the pipes from the compressor. Under no circumstances, use the flame torch to disconnect the compressor tubes.
- IV. In case of compressor failure and / or internal contamination of the system, clean the refrigeration circuit with a suitable solvent, following the technical guidelines of the solvent manufacturer.
- V. Before turning the compressor on:
- Check if the voltage specified on the compressor label in accordance with the power grid and system electrical installation, following item 1.1.
- Check if the electrical protection plastic cover is properly inserted.



www.embraco.com



APA Landing Page



APA Catalog



Digital Tools app

embraco
Nidec

NE / NT / NJ

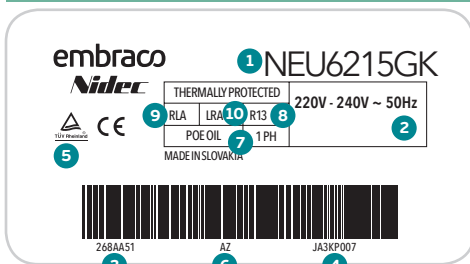

EM / EG / F / VEM / VEG / VNE

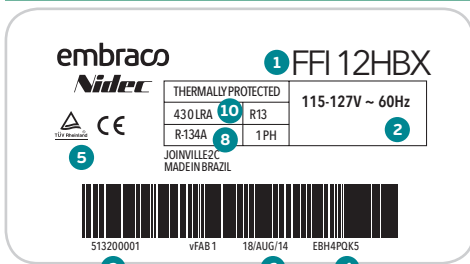

LEGENDA

- | | |
|----------------------|---|
| 1 Compressor model | 6 Production Date |
| 2 Voltage | 7 Oil Type and Quantity |
| 3 SKU code (BOM) | 8 Refrigerant Code |
| 4 Series number | 9 Annual Consumption (nominal current, when applicable) |
| 5 Institute approval | 10 Locked Rotor current (LRA, when applicable) |

WIRING DIAGRAMS

SM00 - EMT/NE SERIES RSIR PTC European Version

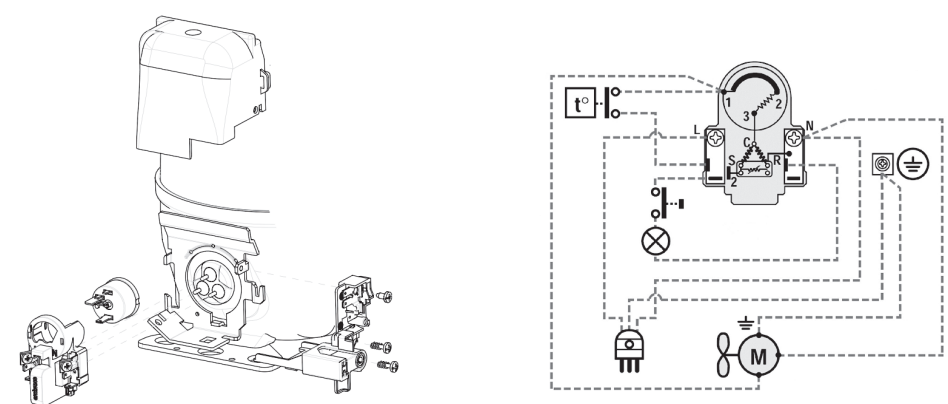

SM03 - EMT/NE SERIES RSIR Terminal Board & Start Decice

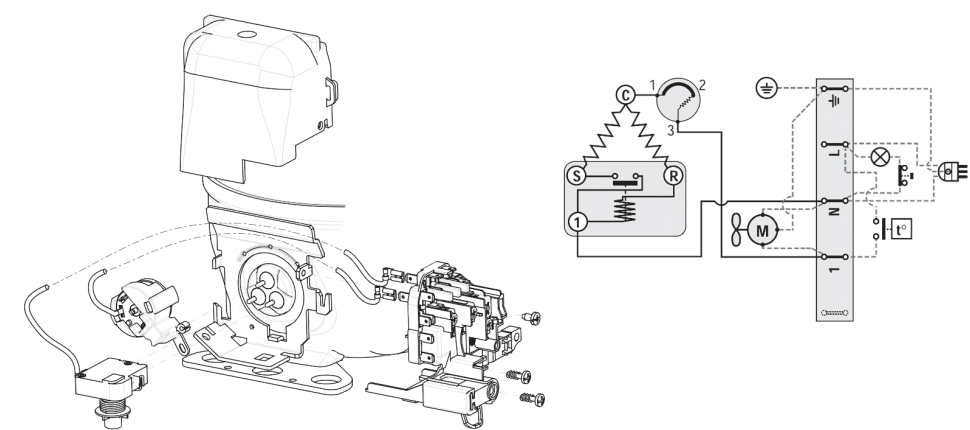

SM06 - NE SERIES CSR Box

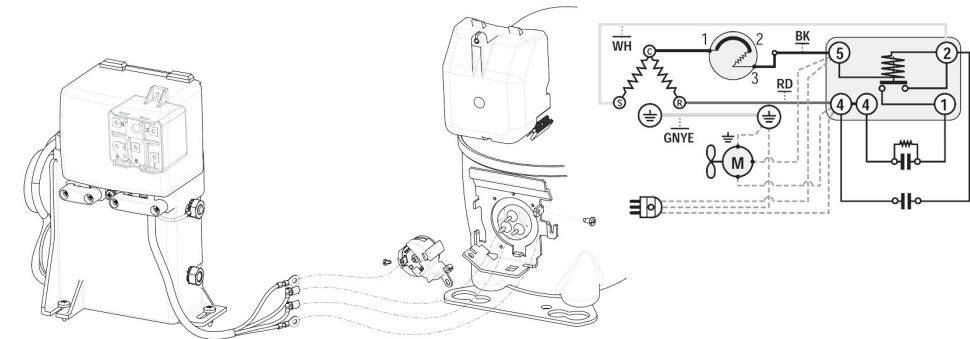

SM07 - EM/EMI

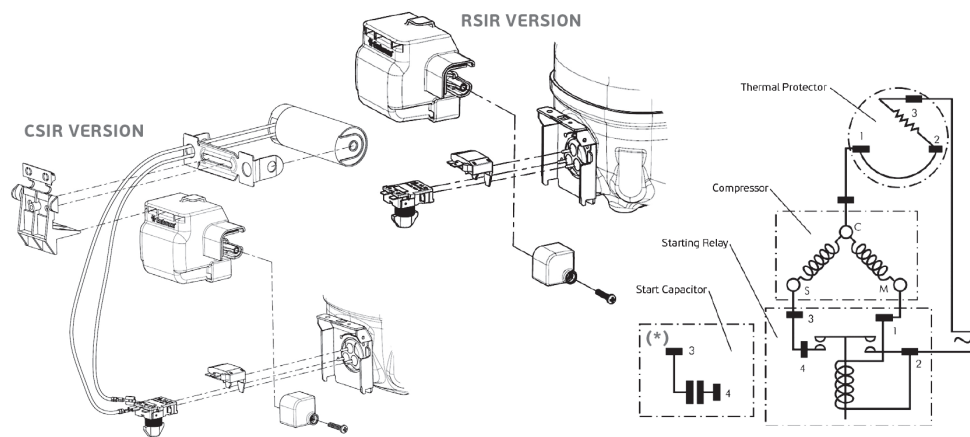

SM09 - EG

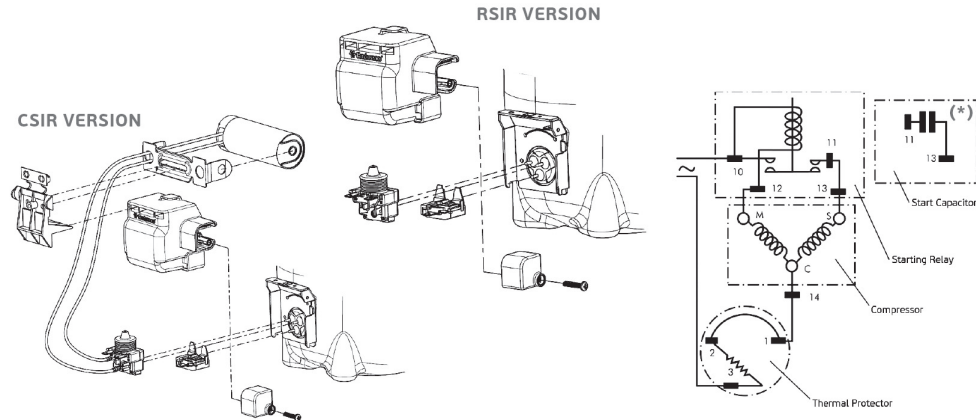

SM14 - NJ CSIR Box

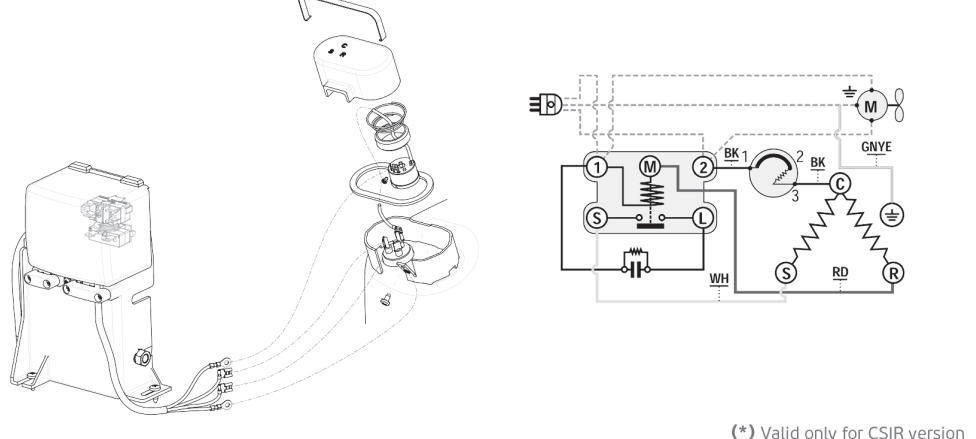

(*) Valid only for CSIR version

SM19 - NT SERIES CSIR Terminal Board

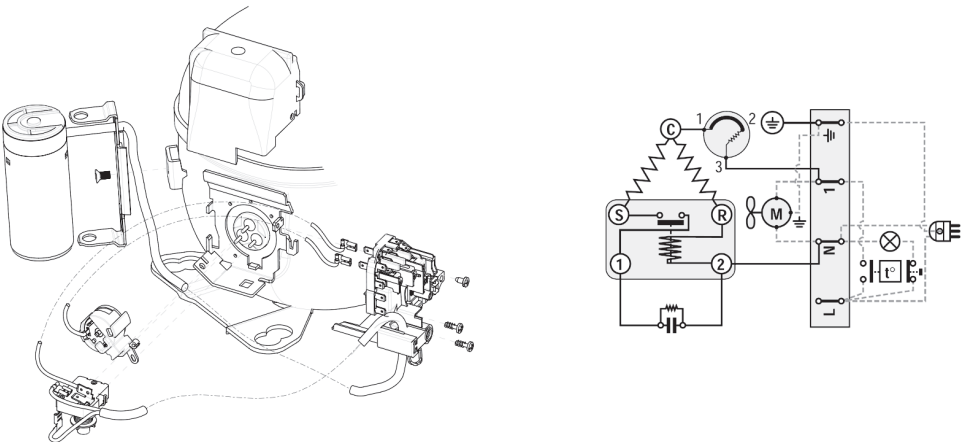

SM21 - NT SERIES CSR Box

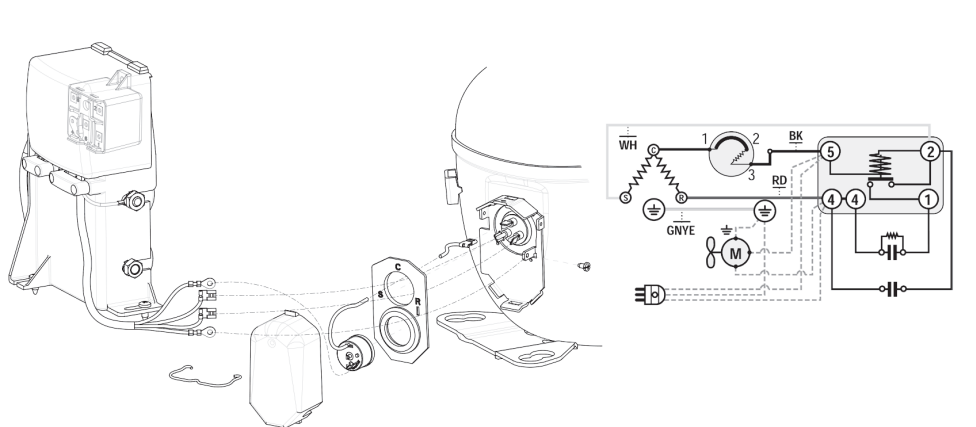

COMPRESSORS ON-OFF

DIMENSIONS		
diameter (mm)		
Suction	6.10	
Process	6.10	
Discharge	4.94	
EM		
EG		
F		
NE		
NT		
NJ		